

**Guide Navigation**

1. How to link Linxura with Alexa.
2. How to use Linxura to control device through Alexa.

**Alexa Setup Guide Video Link:**

<https://www.linxura.com/pages/amazon-alexa>

### 1. How to link Linxura with Alexa.

Make sure your Alexa device is set up in the Alexa app and functioning properly.

Step 1:

Open your Linxura app and then select the Linxura you want to bind with Alexa.

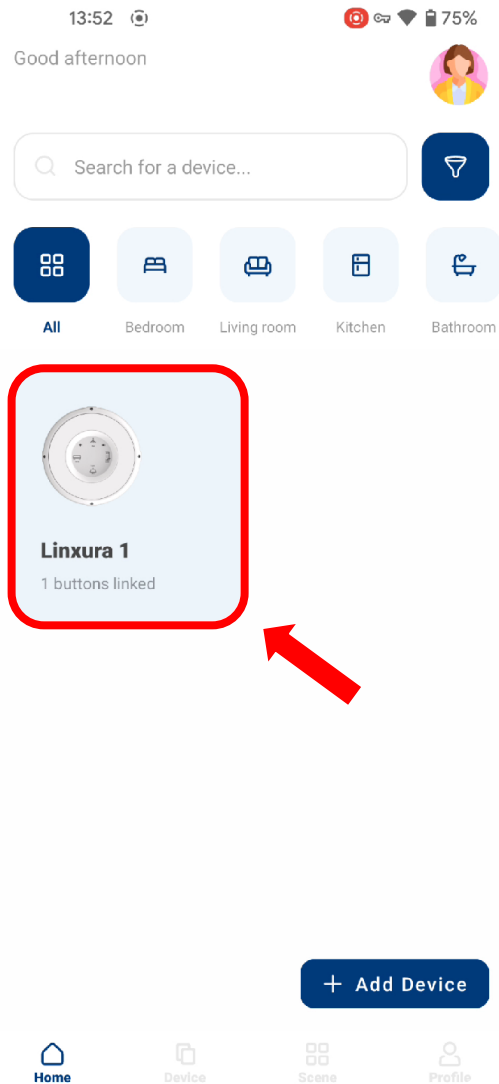

Step 2:

Choose a button.

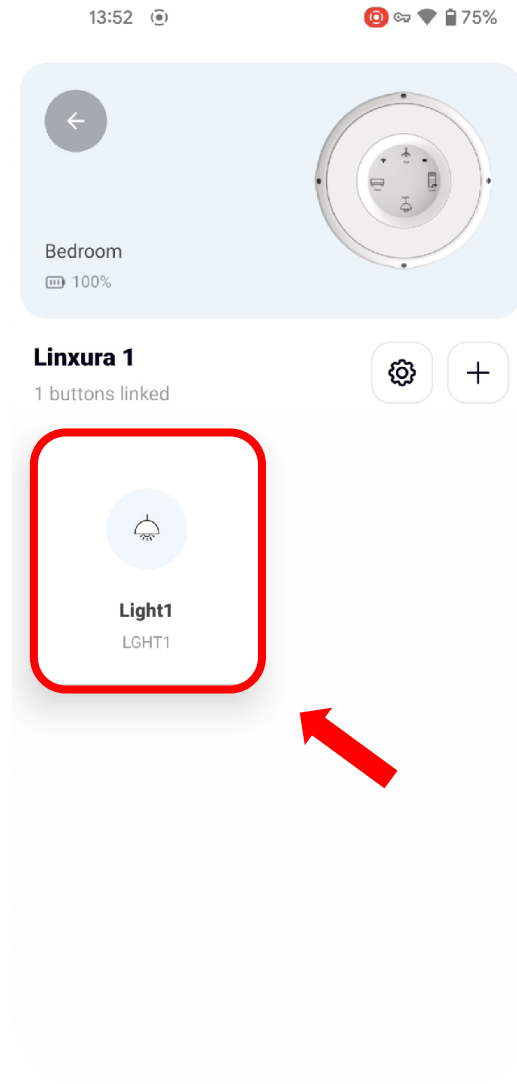

Step 3:  
Click 'Select platform'.

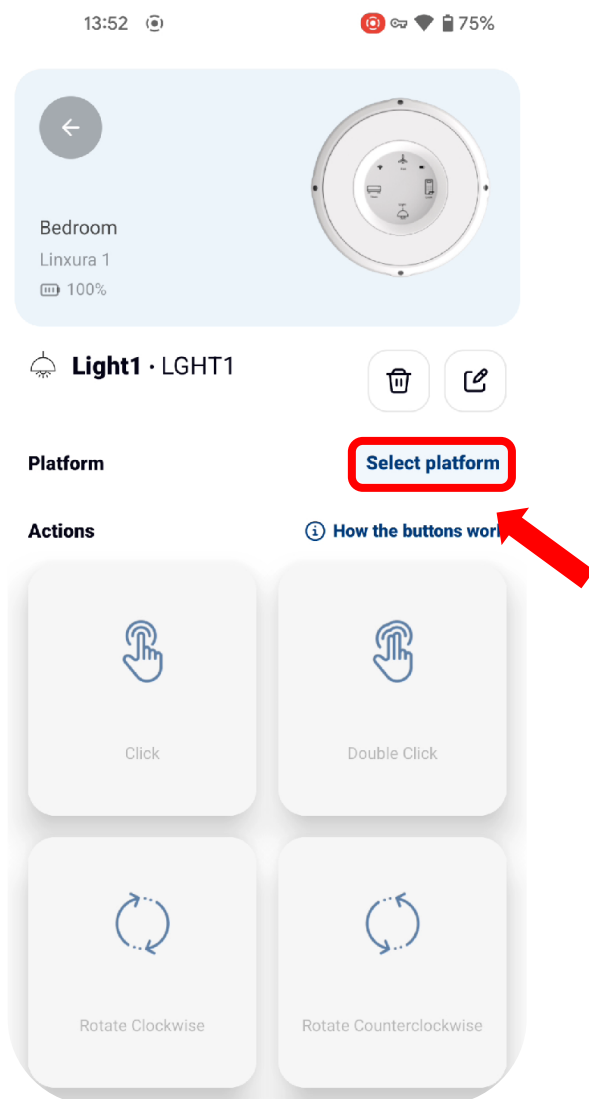

Step 4:  
Select 'Alexa'.

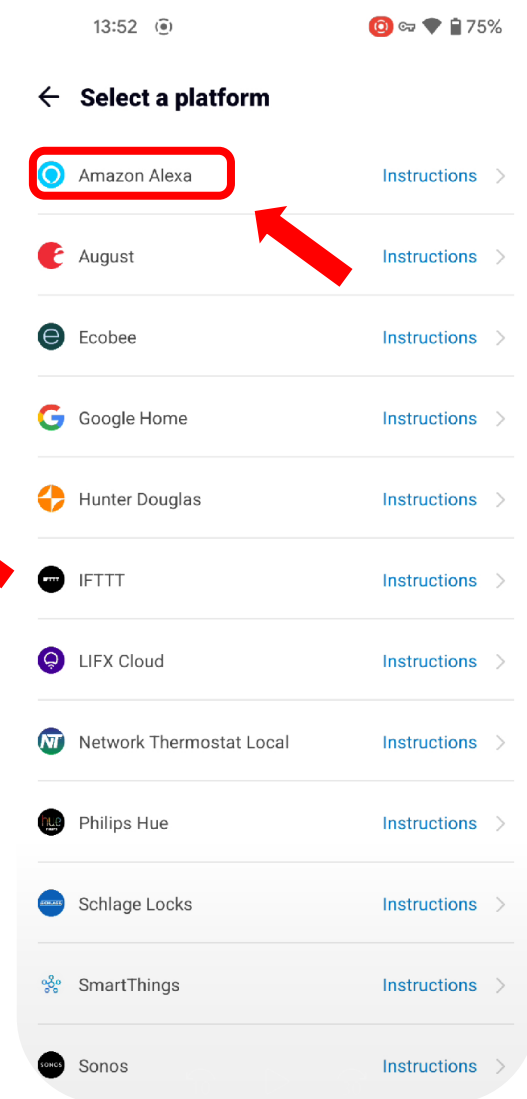

Step 5:  
Click 'Confirm'.

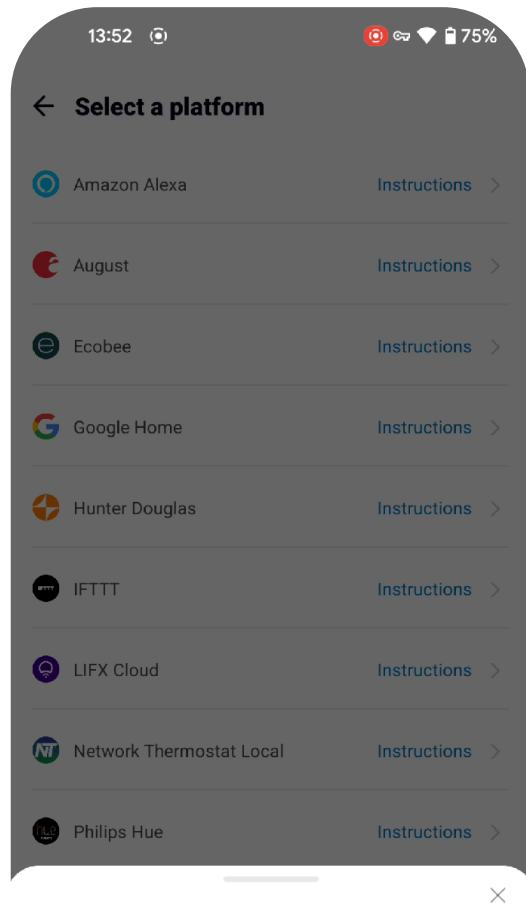

**Attention**

Authorization required.



Step 6:  
Click 'LINK'.

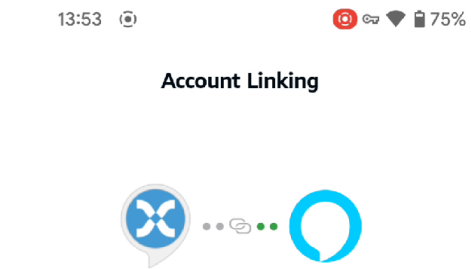

**Link Linxura with Alexa**

Enable the Linxura skill and link your account with Alexa.

To unlink your account at any time, disable the skill in the Alexa app.

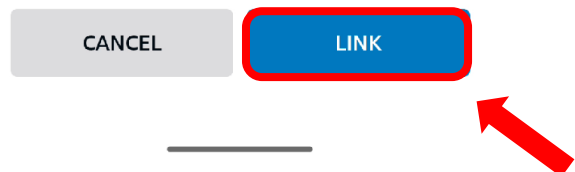

Step 7:  
Click 'Confirm'.

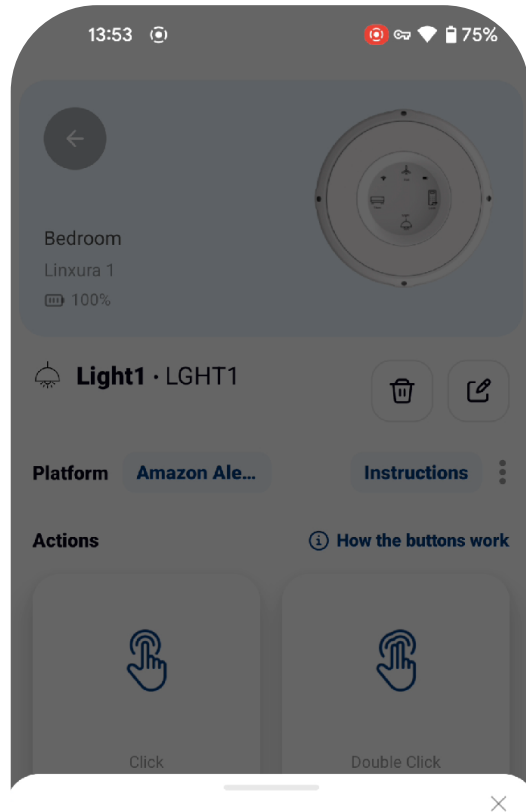

**Success!**

You will see the following device name in Alexa:  
**Linxura 1-Light1**

☐ Don't show this message again.

**Confirm**

## 2. How to use Linxura to control device through Alexa.

Step 1:

Open your Alexa app and click 'More' in the bottom-right corner.

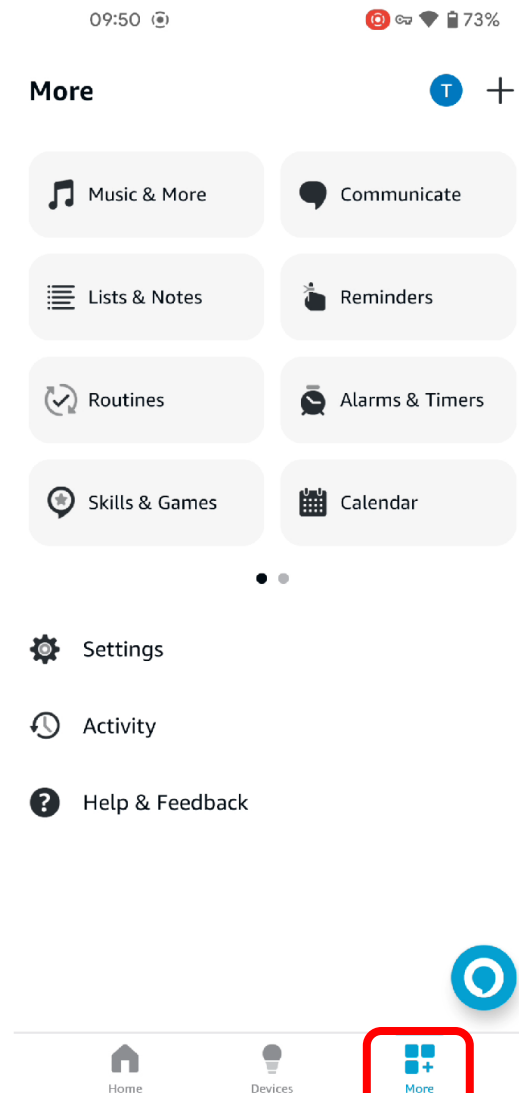

Step 2:  
Click 'Routines'.

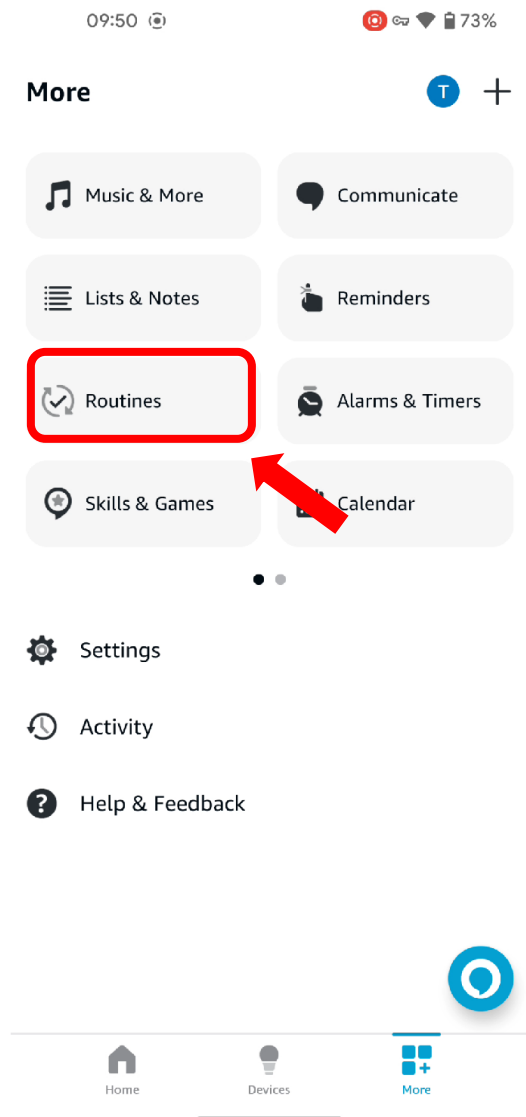

Step 3:  
Click the '+' icon on the top right corner.

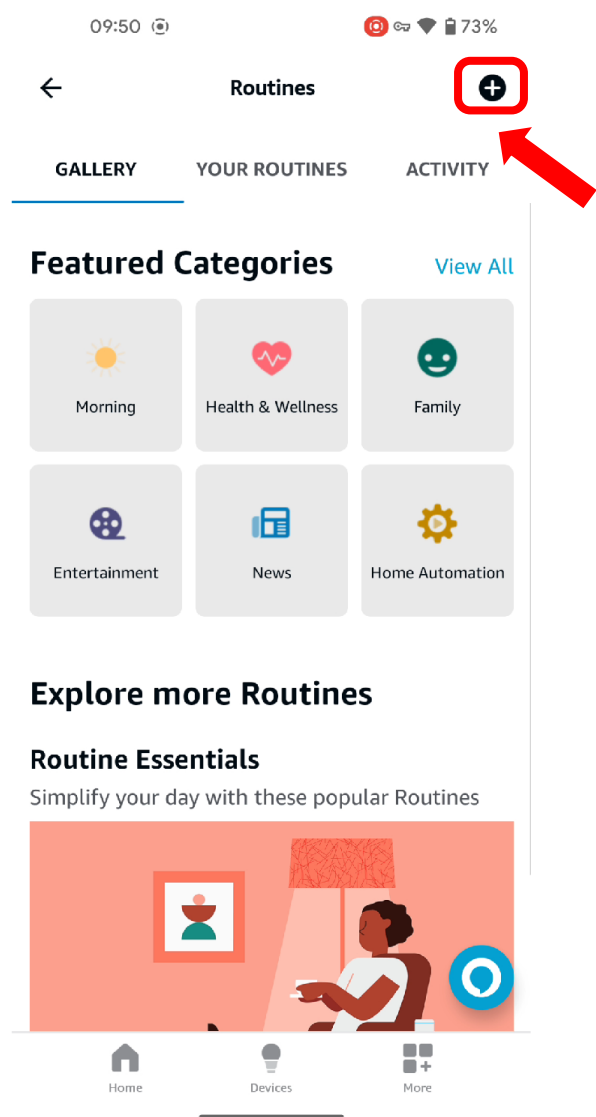

Step 4:  
Click "+" icon on 'WHEN' panel.

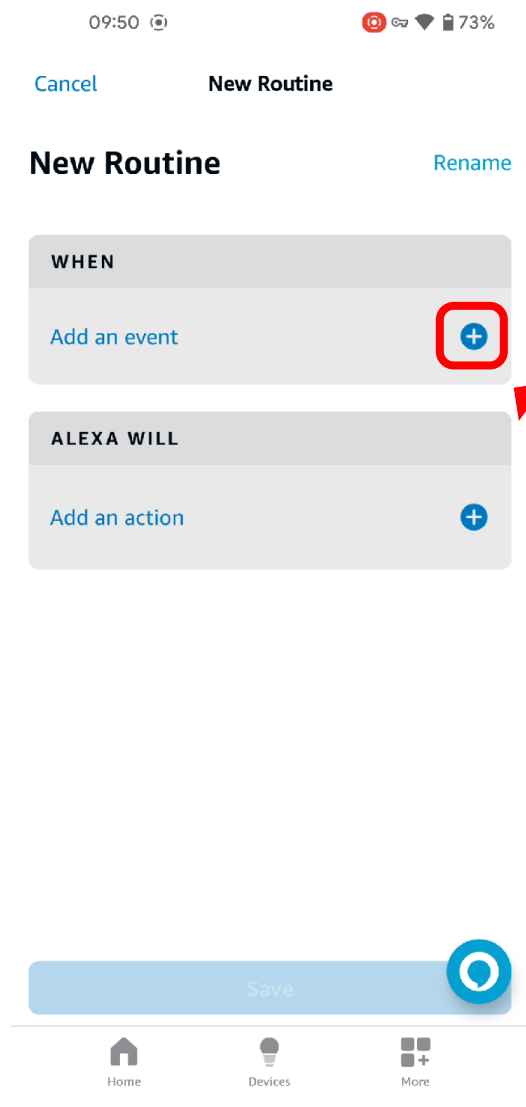

Step 5:  
Click 'Smart Home'.

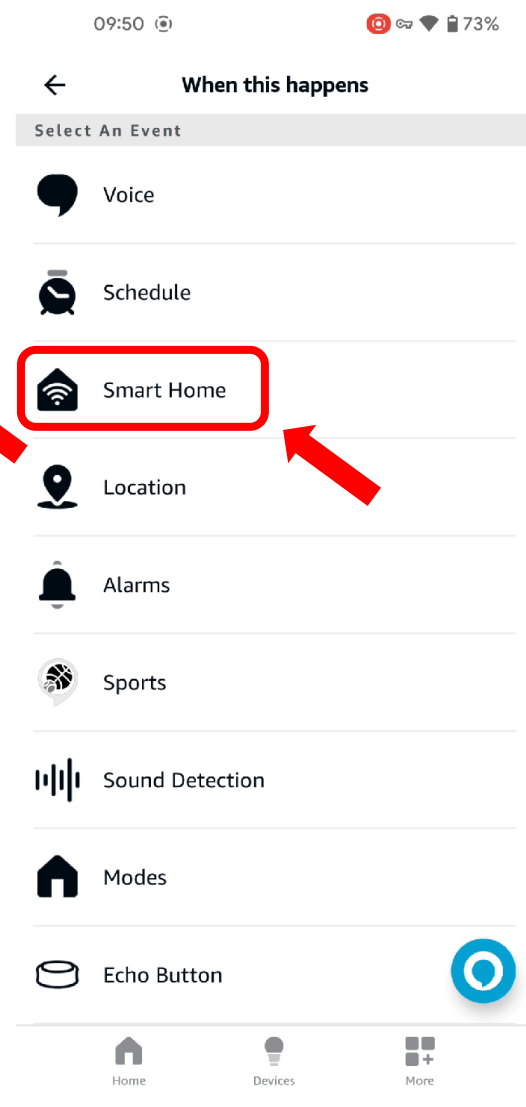

Step 6:  
Select one Linxura button.

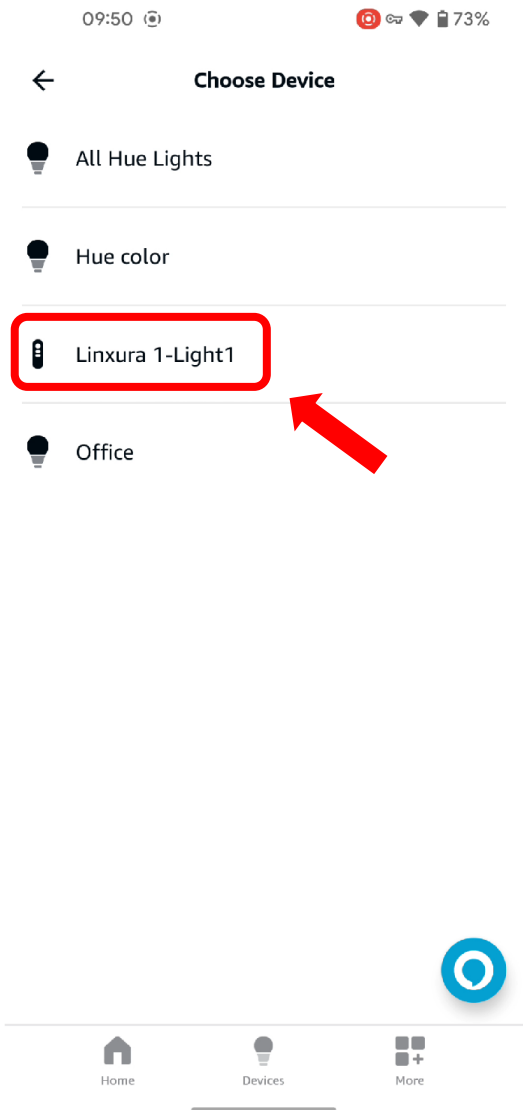

Step 7:  
Select one trigger.

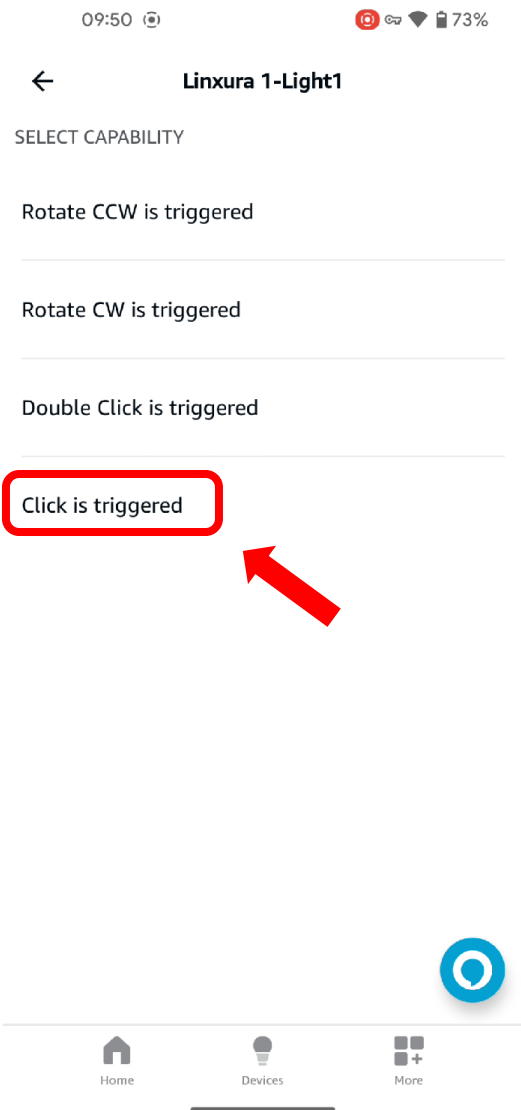



Step 8:  
Check trigger description.

Step 9:  
Click 'Next' on upper right corner.

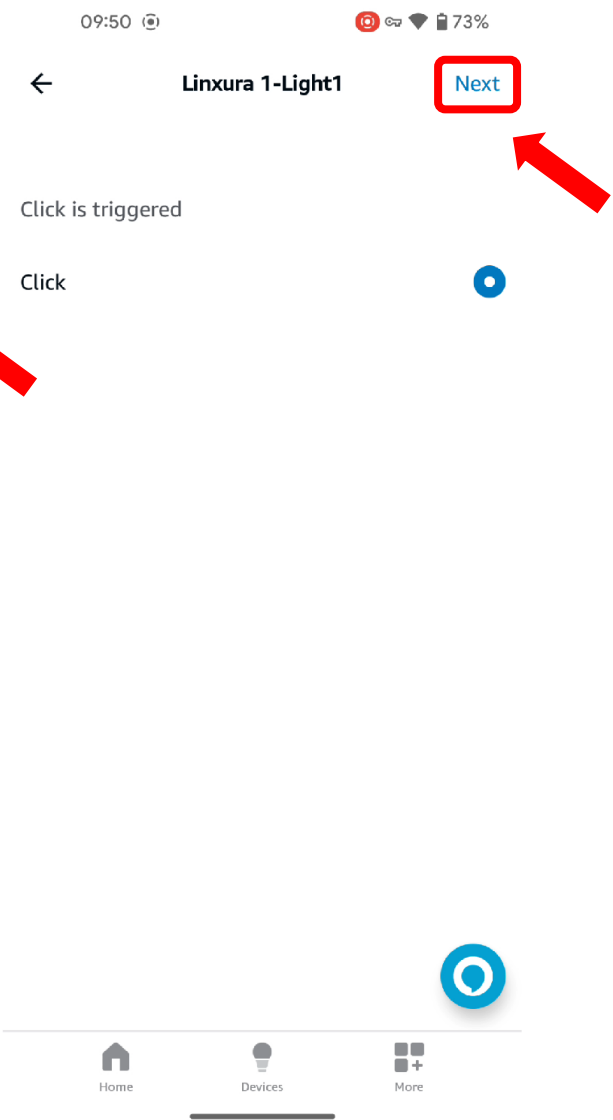

Step 10:  
Click "+" icon on 'ALEXA WILL' panel.

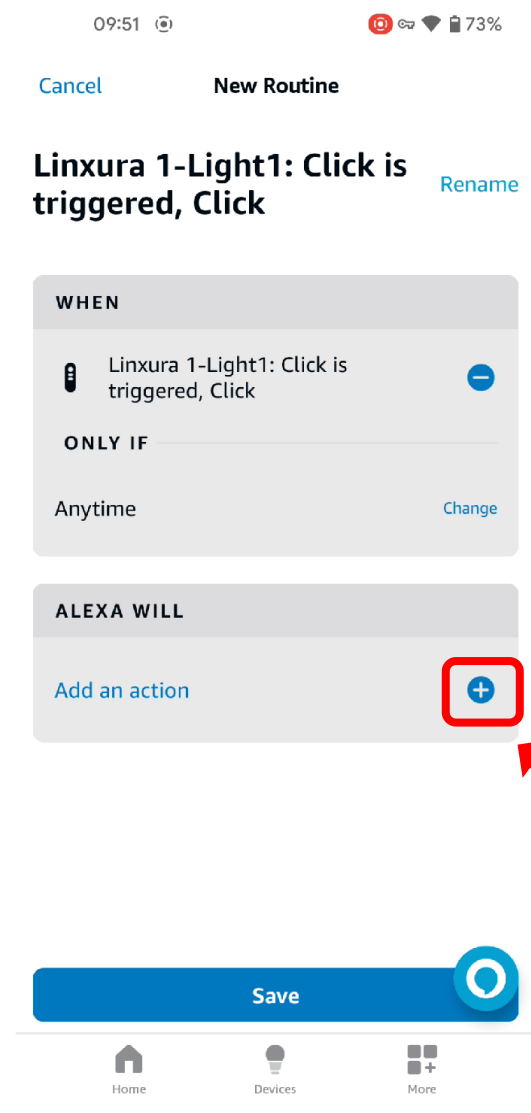

Step 11:  
Click 'Smart Home'.

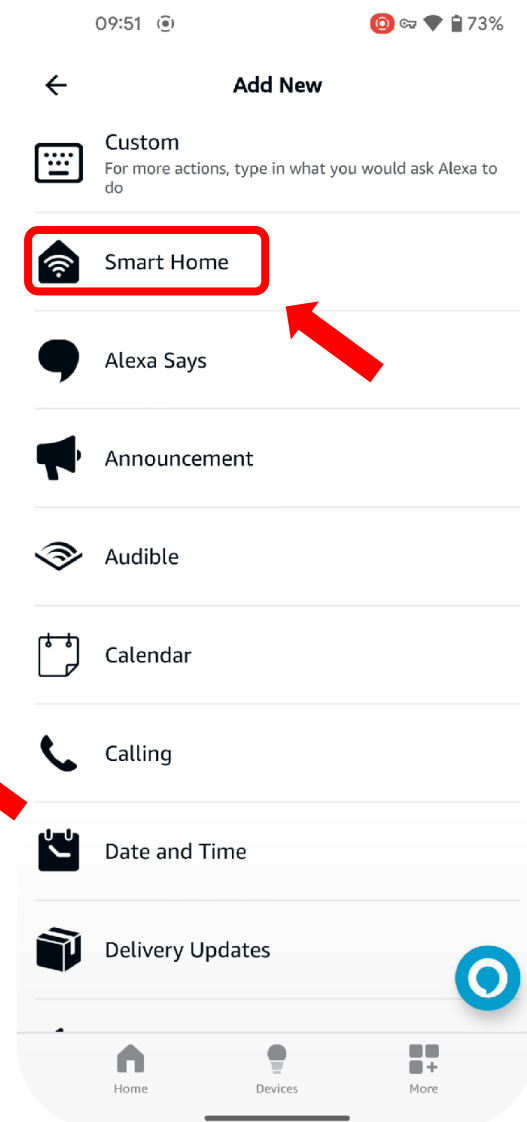

Step 5:  
Click 'All Devices'.



Step 6:  
Select one of devices.

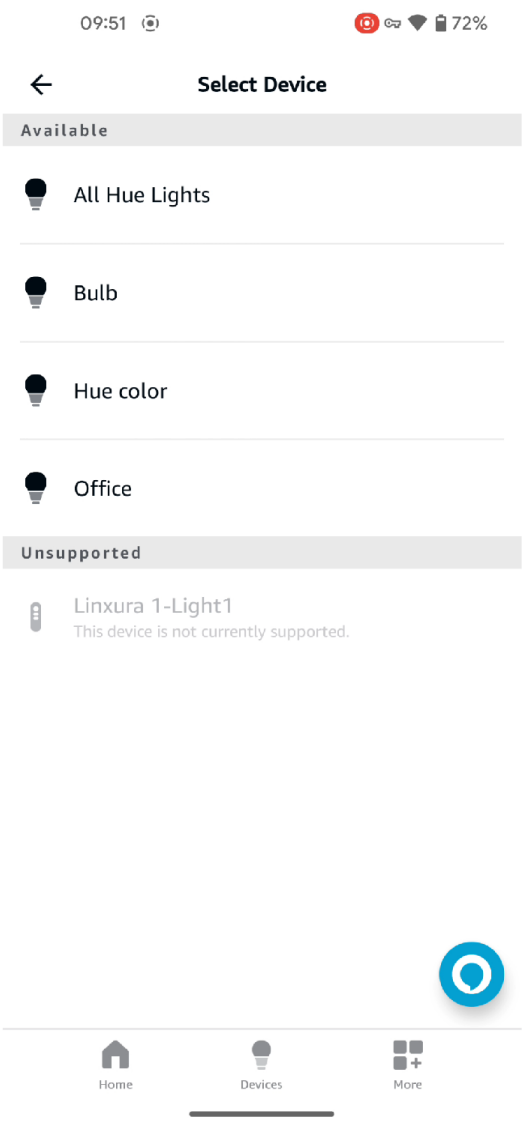

Step 7:

Select an action and click 'Next' on upper right corner.

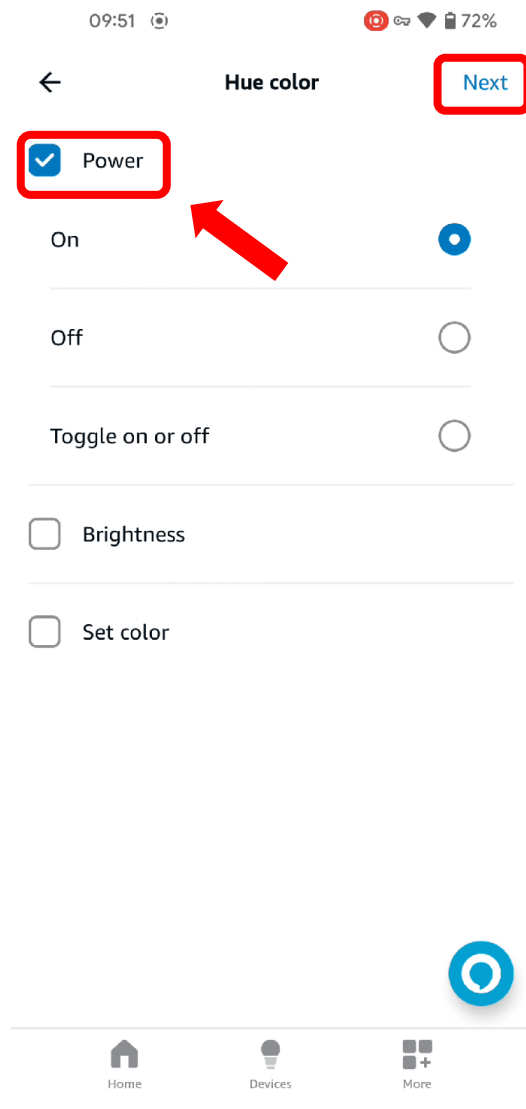

Step 8:

Click 'Save' to add this new routine.

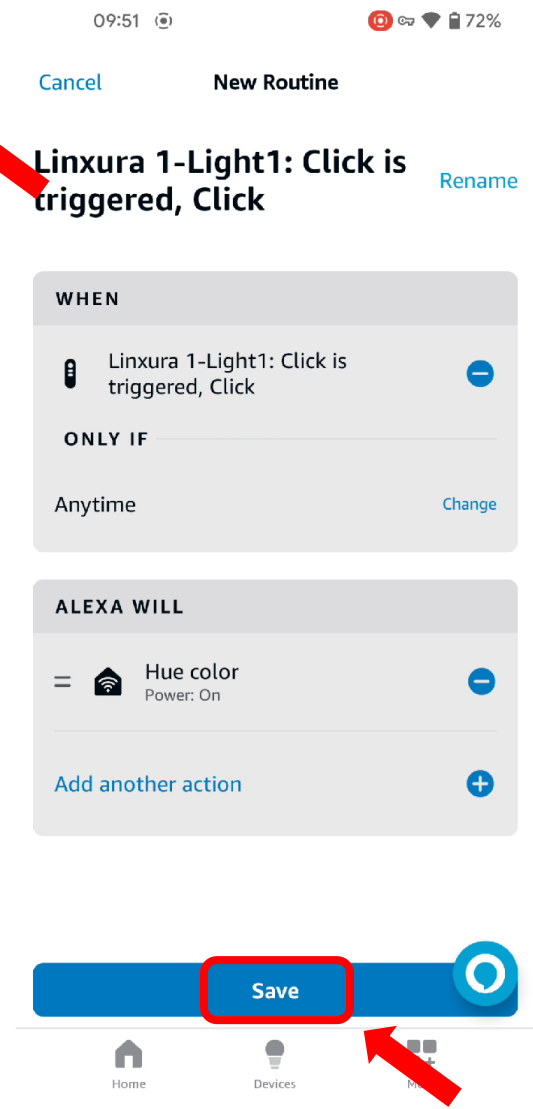

Step 9:

You can follow the same steps to configure Double Click, Rotate Clockwise, and Rotate Counterclockwise.

You can now use Linxura to control device through Alexa!

