

## Guide Navigation

1. How to link Linxura with Sonos.
2. How to use Linxura to control Sonos speakers.

## Sonos Setup Guide Video Link

<https://www.youtube.com/watch?v=bgE7G-cojFU>

### 1. How to link Linxura with Sonos.

Make sure your Sonos account has connected speakers.

#### Step 1

Open your Linxura app and then select the Linxura you want to bind with Sonos.

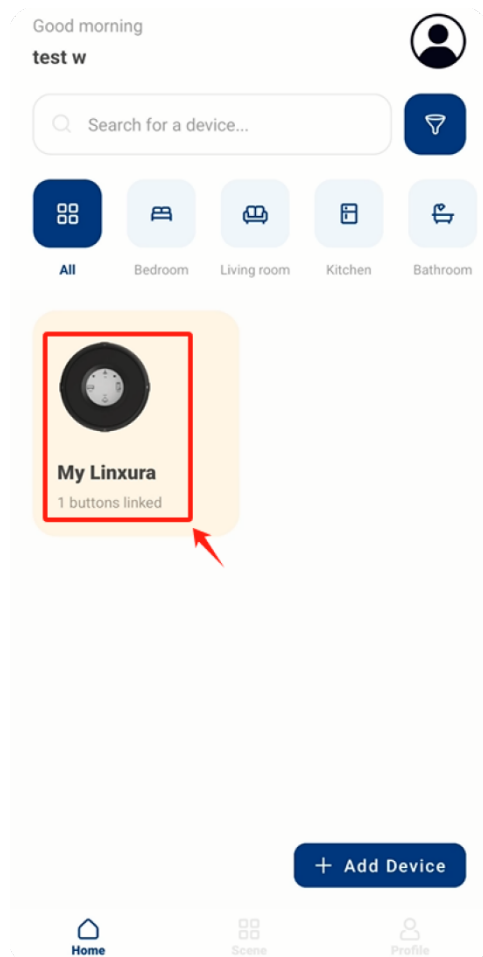

#### Step 2

Choose a button, then click 'Select platform' and select 'Sonos'.

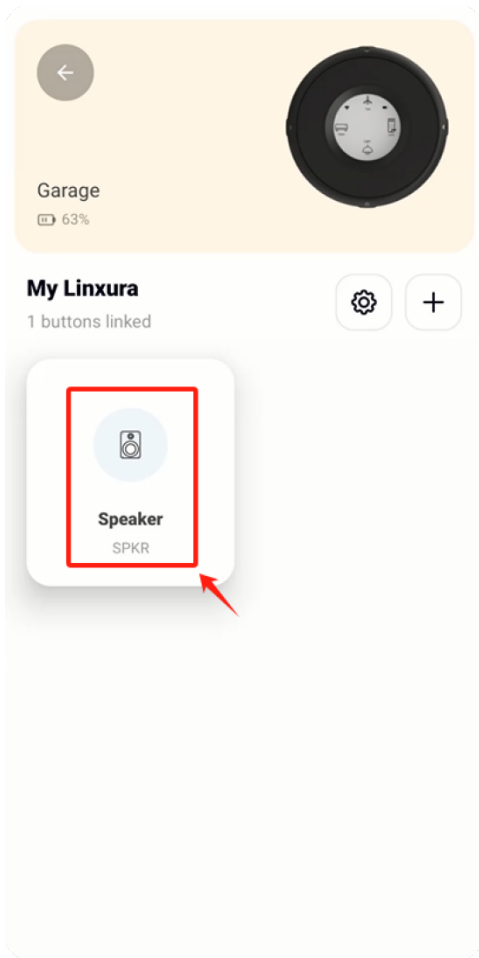

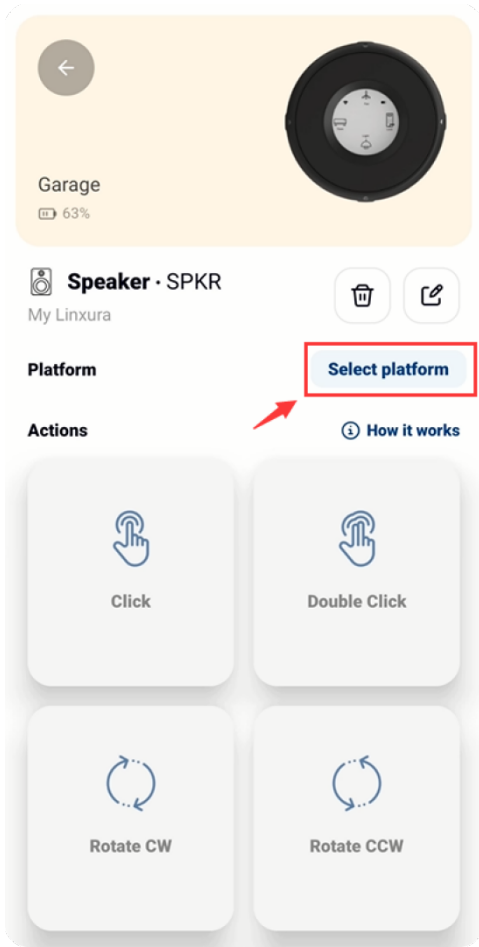

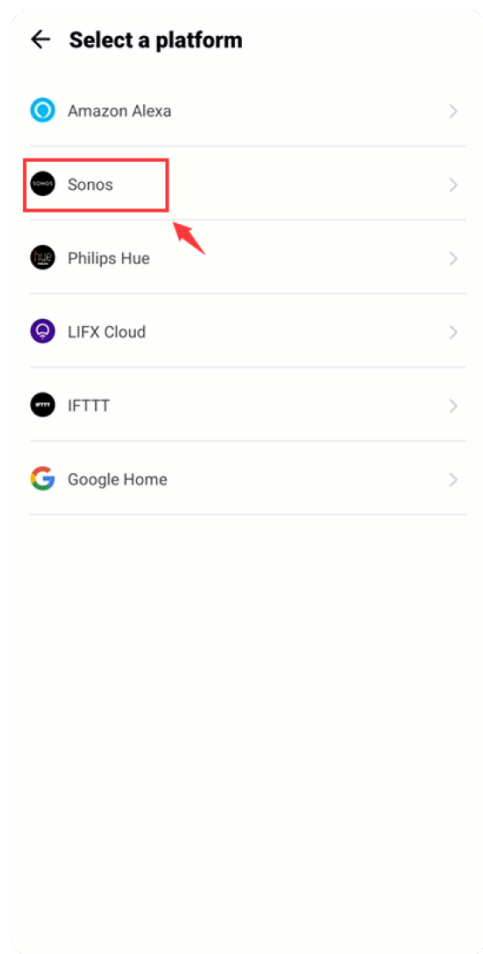

### Step 3

Click 'Confirm' to complete the authorization.

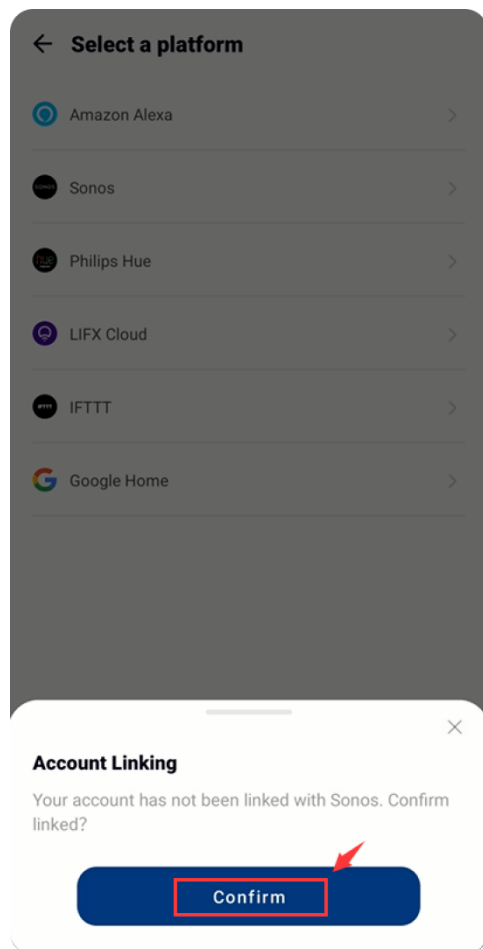

# SONOS

## Before you get started...

Have your account info handy. You can find it here in the Sonos app: **More > Settings > Account Settings**.

Continue



## Step 4

Login to your Sonos account and authorize Linxura.

# SONOS

Sign into your Sonos account

xxxxxxx@xxxxxxx.com

.....|



Sign in

 I forgot my password



# SONOS

## Allow Linxura to control your Sonos system

This gives Linxura permission to:

- See what your Sonos is playing
- Change playback and volume on your Sonos
- Change your Sonos rooms and groups
- Play your Sonos favorites and playlists

You agree that Linxura is responsible for its use of your information according to its privacy policy. Use of Sonos products is subject to the Sonos Privacy Policy.

Okay

Don't allow

## Step 5

Select the speaker to be controlled.



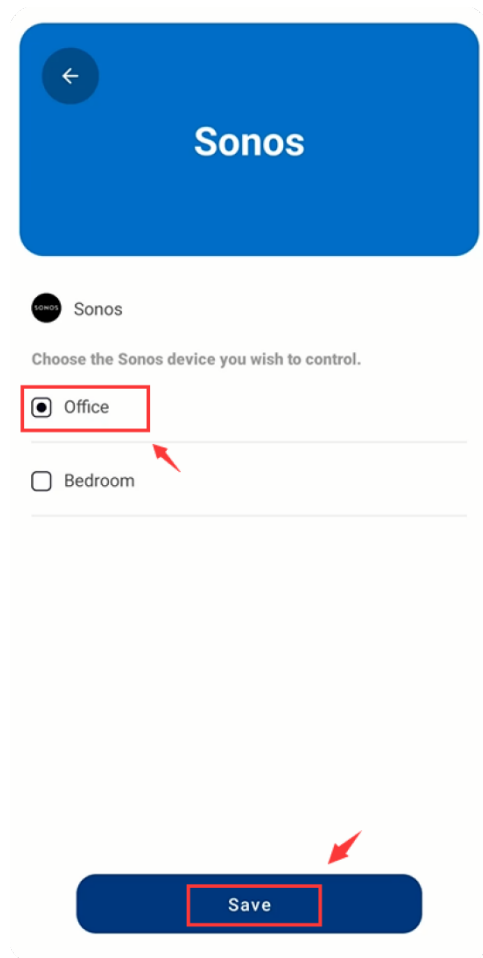

## 2.How to use Linxura to control Sonos speakers.

### Step 1

Click the '+' icon to add a Click Action.

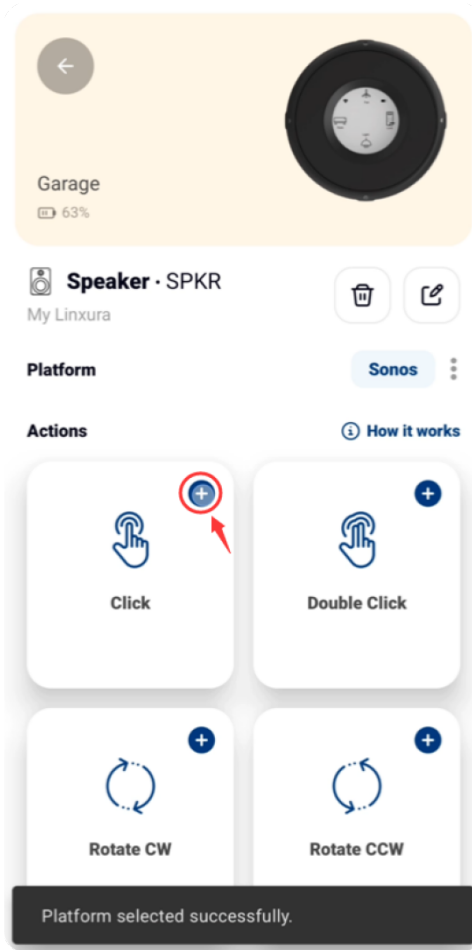

## Step 2

Click 'Mode' and select one of the options.

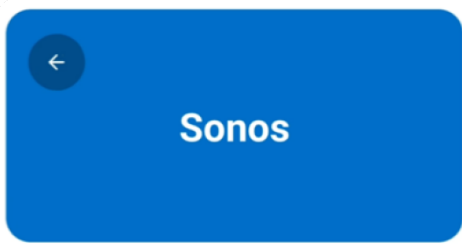

 Sonos

[READ MORE](#)

SOUND

Office

ACTION: CLICK

Mode:



Save

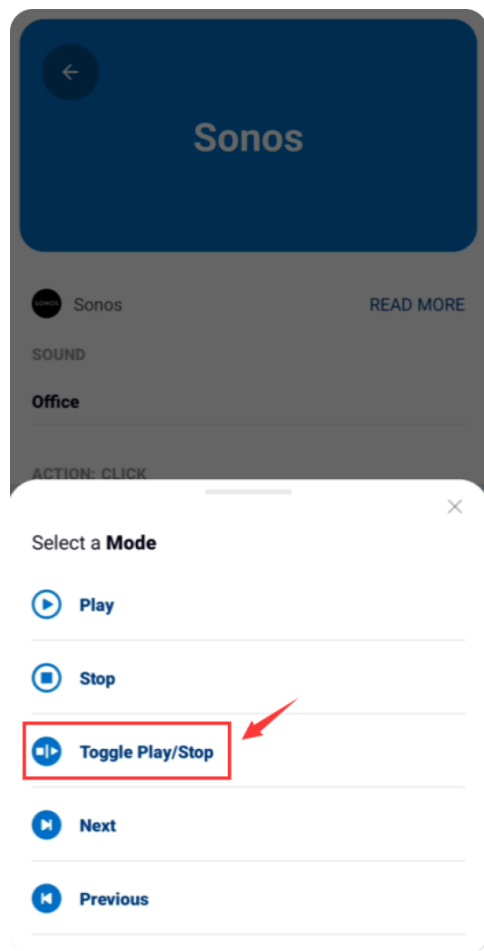

### Step 3

Select 'Playlist' to access the playlist you have created on your Sonos.



Sonos

 Sonos

READ MORE

SOUND

Office

ACTION: CLICK

Mode: Toggle Play/Stop >

Playlist: >

Volume: >

Save

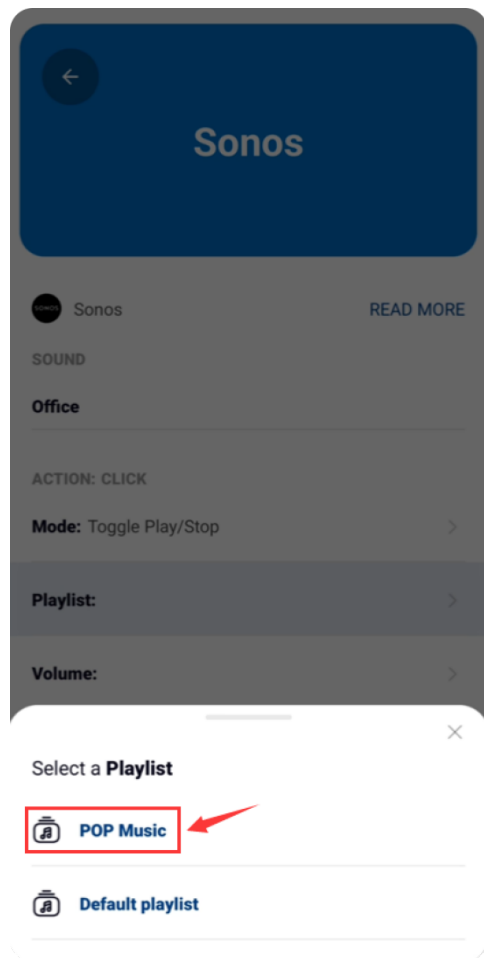

#### Step 4

Click 'Volume' to set the volume of the speaker.



Sonos

 Sonos

READ MORE

SOUND

Office

ACTION: CLICK

Mode: Toggle Play/Stop >

Playlist: POP Music >

Volume: >

Save

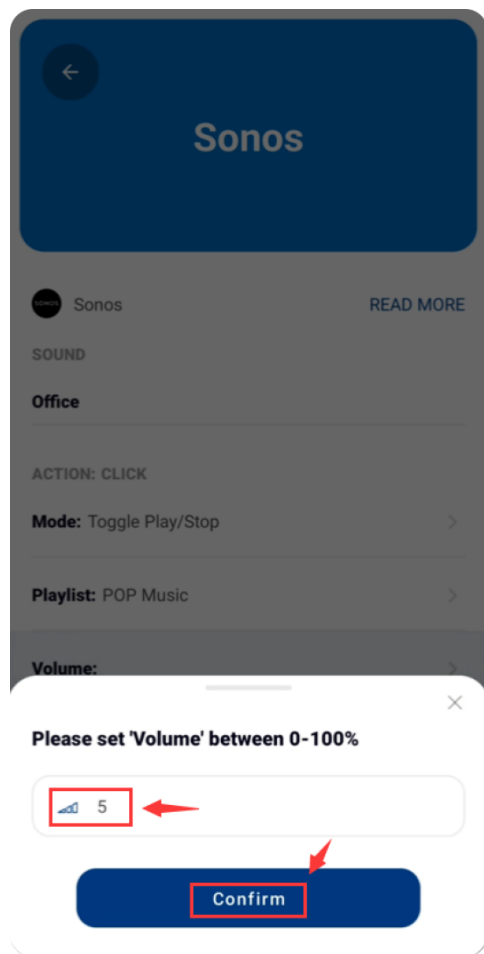

Step 5  
Click 'Save' to save the Click Action settings.



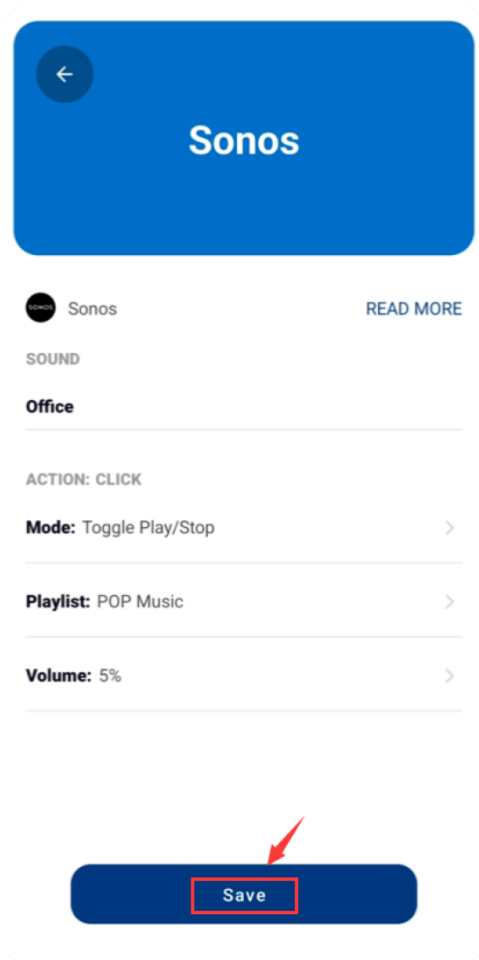

## Step 6

Click the '+' icon to add a Double Click Action.

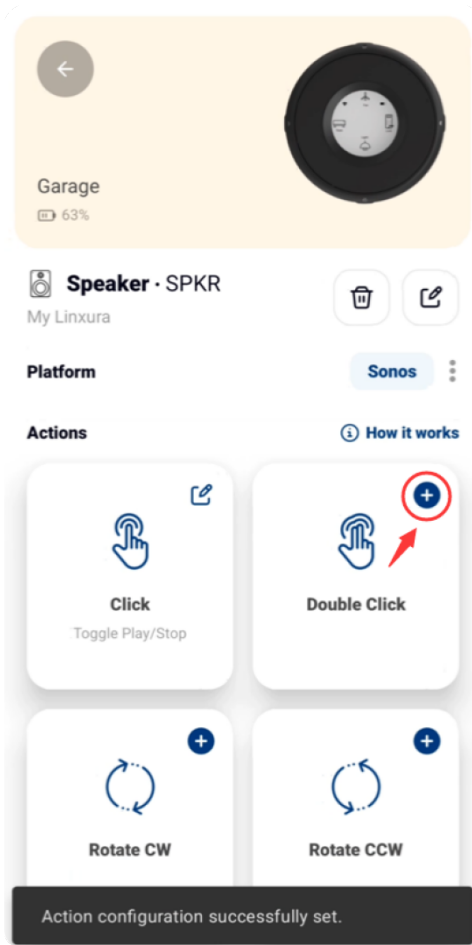

## Step 7

Click 'Mode' and select one of the options.

Sonos

Sonos

READ MORE

SOUND

Office

ACTION: DOUBLE CLICK

Mode:

Save

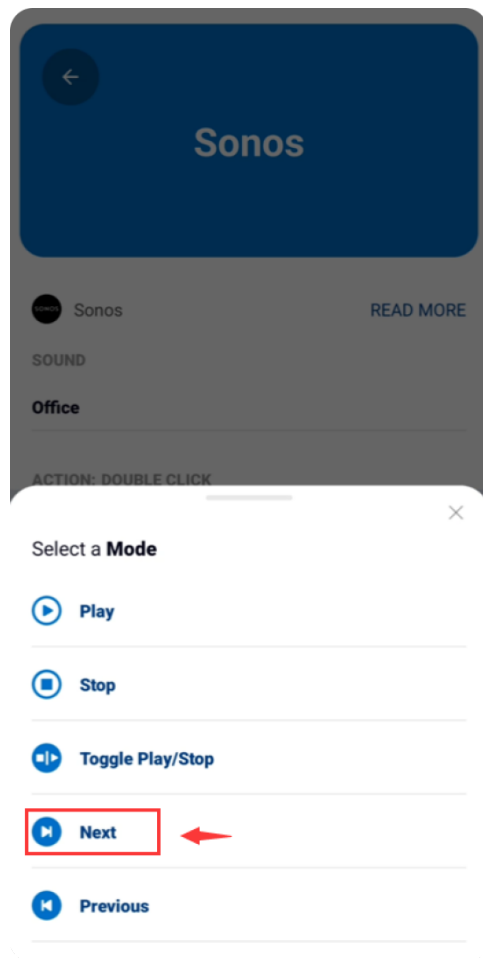

## Step 8

Click 'Save' to save the Double Click Action settings.

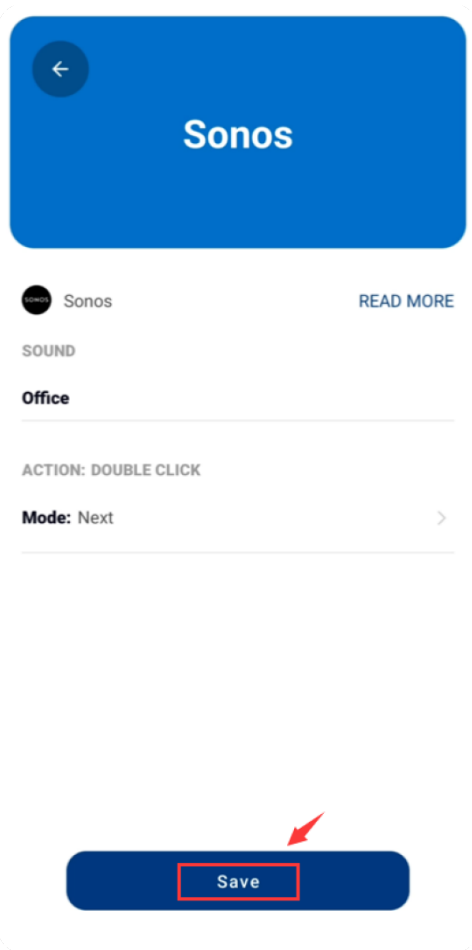

## Step 9

Click the '+' icon to add a Rotate Clockwise(CW) Action.

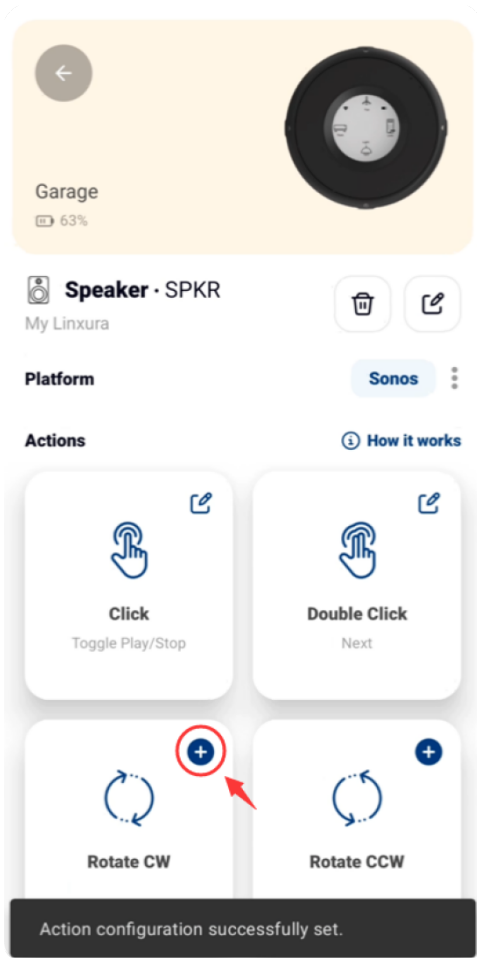

## Step 10

Click 'Mode' and select one of the options.



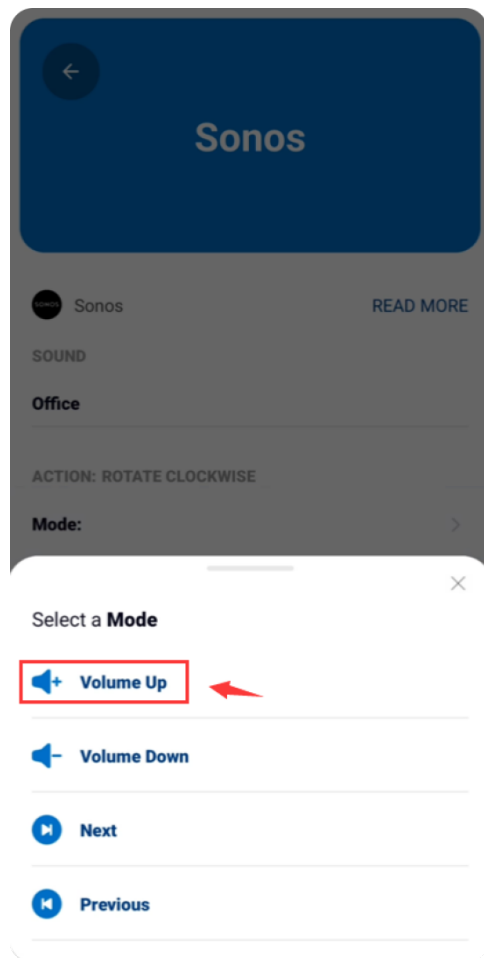

### Step 11

Click 'Save' to save the Rotate Clockwise(CW) Action settings.



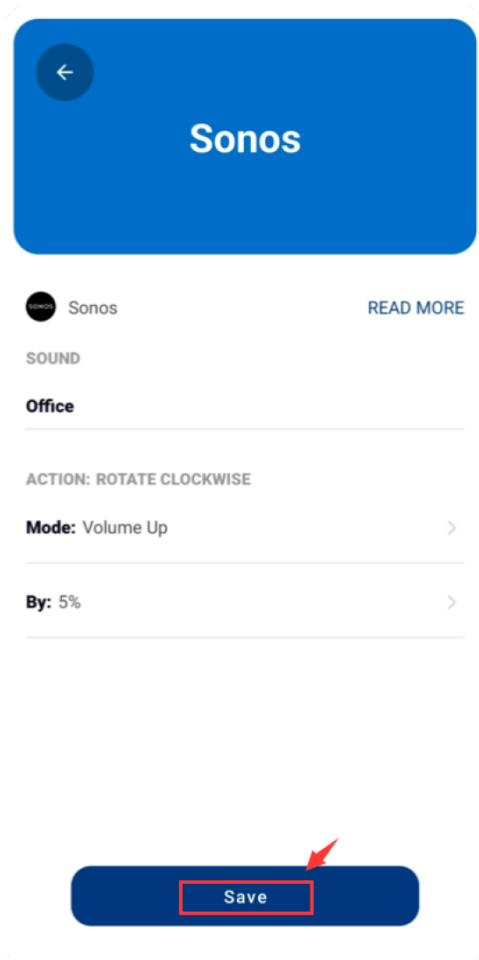

## Step 12

Click the '+' icon to add a Rotate Counterclockwise(CCW) Action.

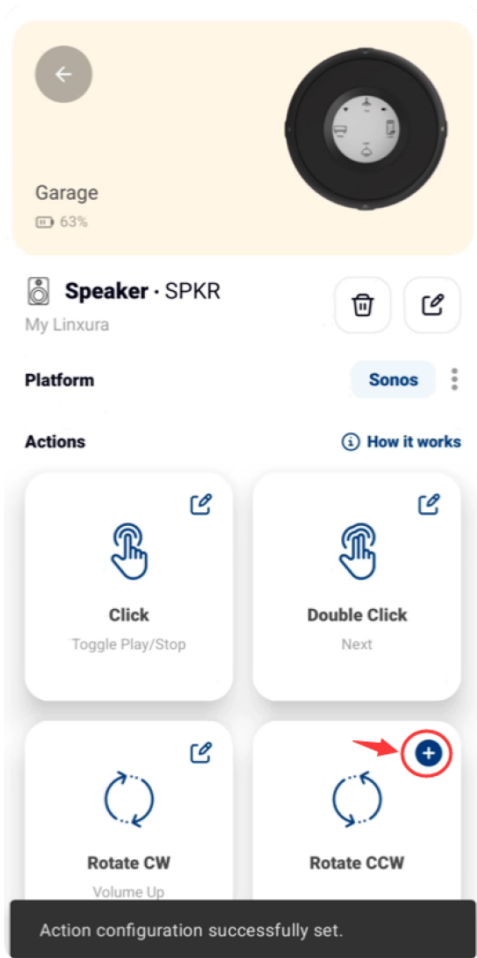

### Step 13

Click 'Mode' and select one of the options.

Sonos

Sonos

READ MORE

SOUND

Office

ACTION: ROTATE COUNTERCLOCKWISE

Mode:

Save

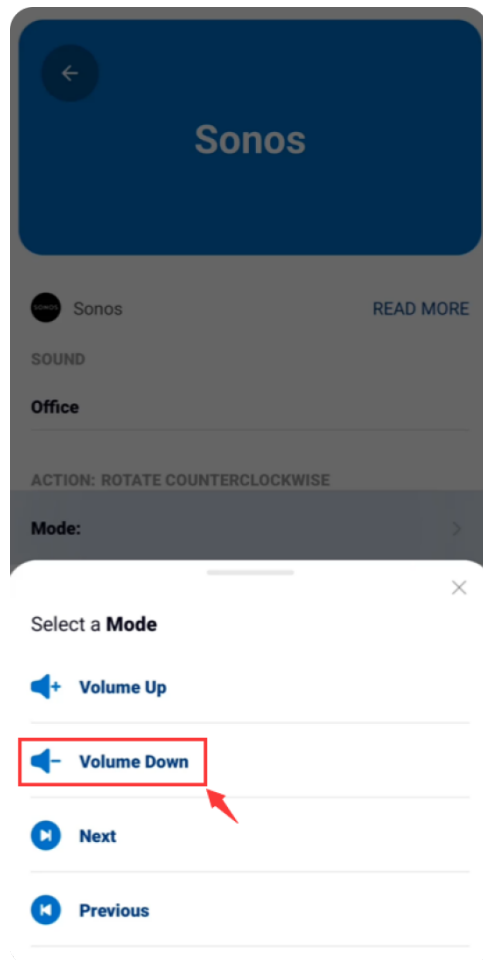

#### Step 14

Click 'Save' to save the Rotate Counterclockwise(CCW) Action settings.

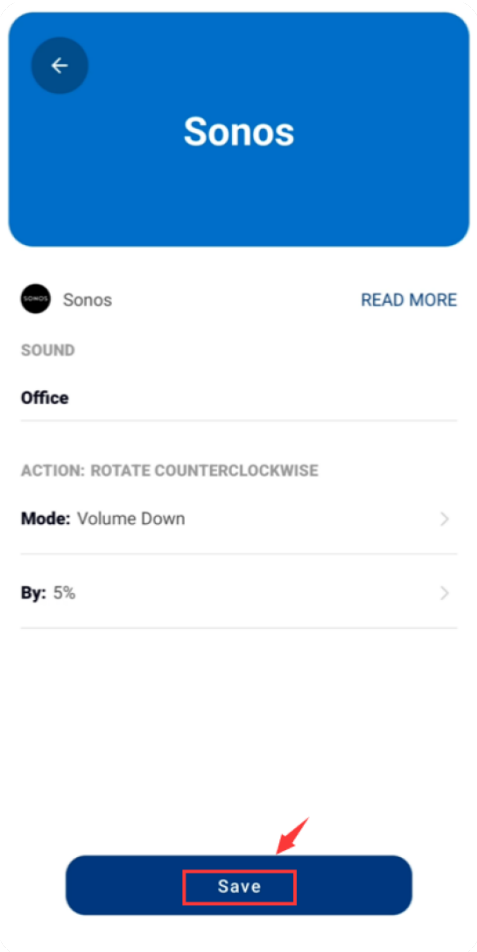

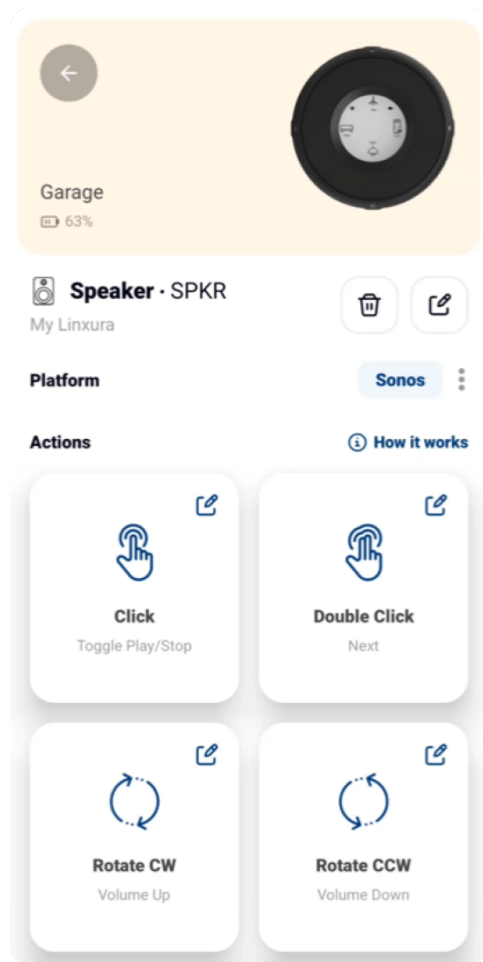

You can now use Linxura to control your Sonos speakers!