

Guide Navigation

1. Supported Features for Tapo devices.
2. How to link Linxura with Tapo.
3. How to use Linxura to control Tapo device.

Tapo Setup Guide Video Link:

<https://www.linxura.com/pages/tapo>

1. Supported Features for the Tapo devices

Tapo Light Supported Actions

Actions	Supported Mode	Description
Click/Double Click	Mode: On, Off, Toggle	On: Turn on the light Off: Turn off the light Toggle: Switches between on and off
	Set Color:	Set a preferred color for your light
	Set Brightness	Set the Brightness level from 0 (dim) to 100 (bright)
	Set Color Temperature	Set the Color Temperature from 2700k (warm) to 6500K (cool)
Rotate Clockwise/Rotate Counterclockwise	Brightness Up/Down	Brightness up: Increases the brightness Brightness down: Decreases the brightness
	Color Temperature up/down	Color temperature up: Raises the color temperature Color temperature down: Lowers the color temperature

Tapo Switch Supported Actions

Actions	Supported Mode	Description
Click/Double Click	Mode: On, Off, Toggle	On: Turn on the switch Off: Turn off the switch Toggle: Switches between on and off
	Set Brightness	Set the Brightness level from 0 (dim) to 100 (bright)
Rotate Clockwise/Rotate Counterclockwise	Brightness Up/Down	Brightness up: Increases the brightness Brightness down: Decreases the brightness

Tapo Smart Plug Supported Actions

Actions	Supported Mode	Description
Click/Double Click	Mode: On, Off	On: Turn on the smart plug Off: Turn off the smart plug

1. How to link Linxura with Tapo devices?

Make sure your Tapo device is set up in the Tapo app and functioning properly.

Step 1:

Open your Linxura app and then select the Linxura you want to bind with Tapo.

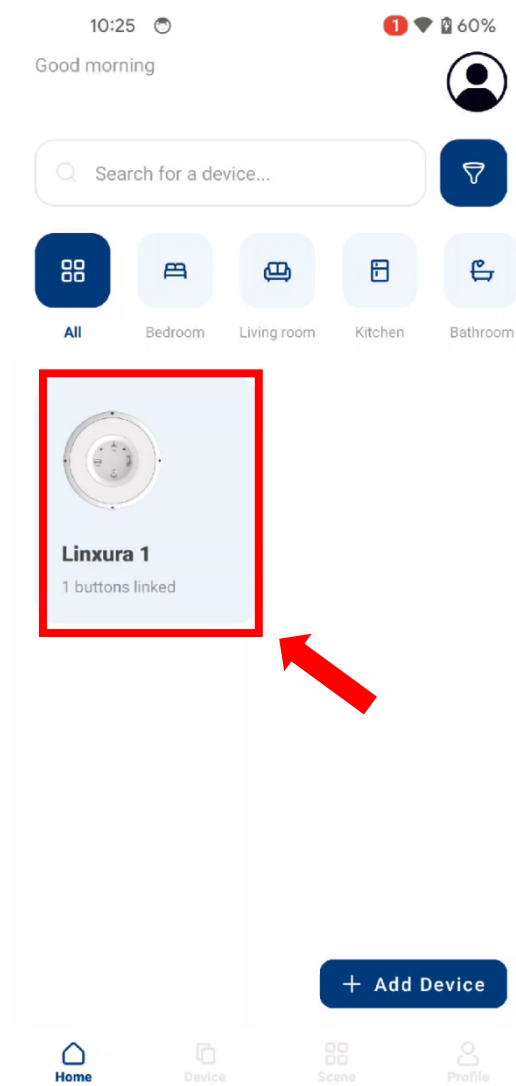

Step 2:

Choose a button.

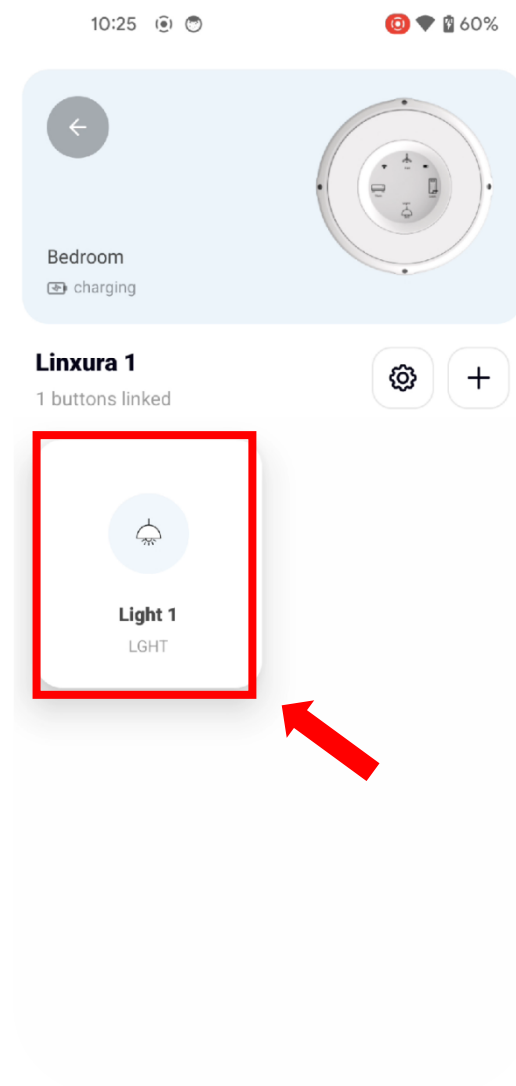

Step 3:
Click 'Select platform'.

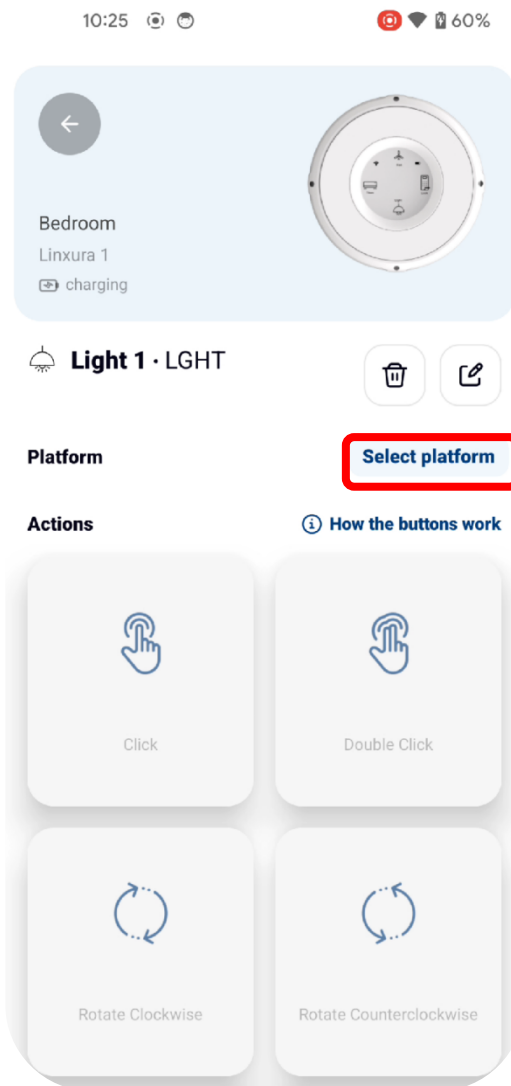

Step 4:
Select 'Tapo' option.

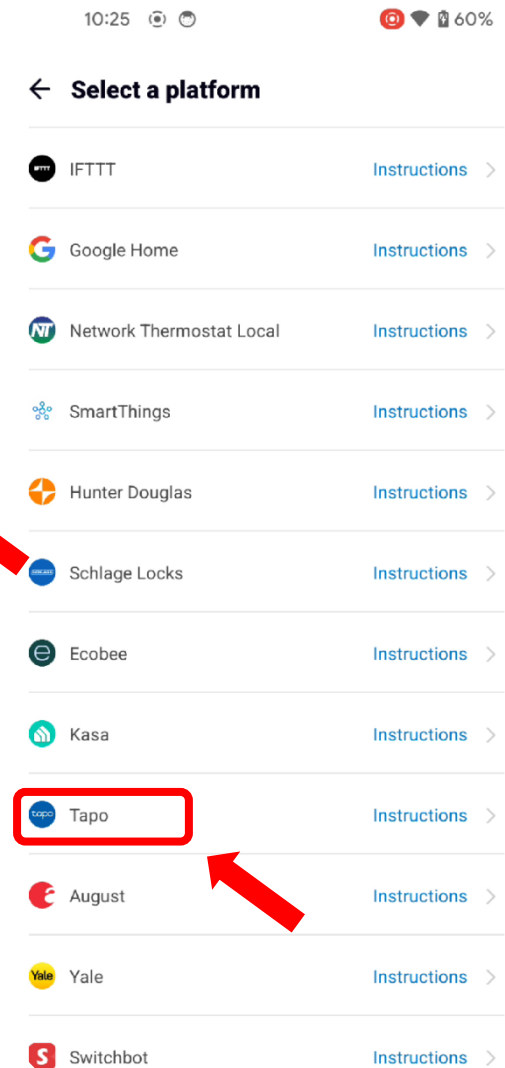

Step 5:

Click 'Confirm' to complete the authorization.

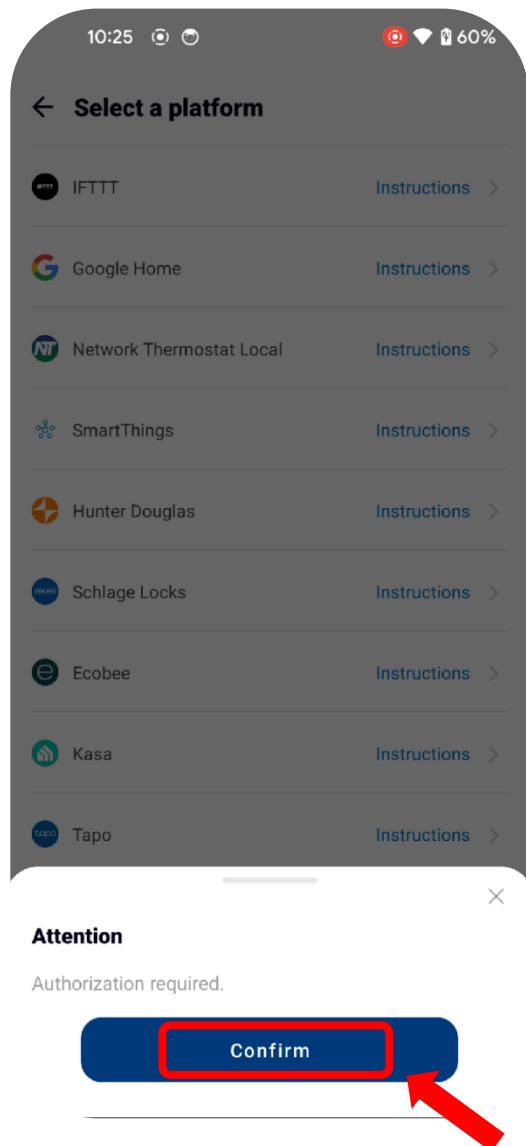

Step 6:

Log in to your Tapo account and authorize Linxura.

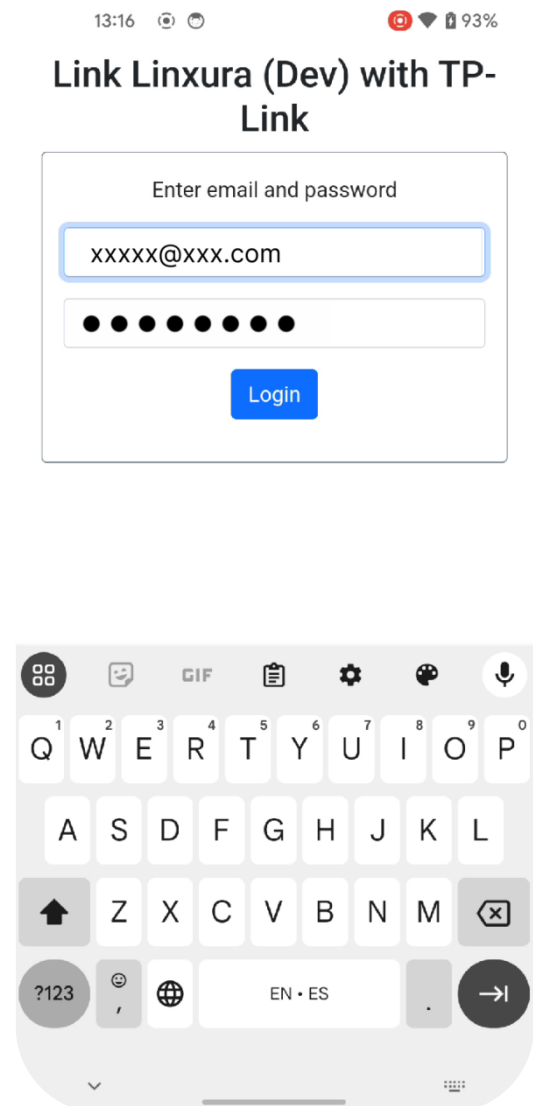

Step 7:

Select the Tapo device and click 'Save'.

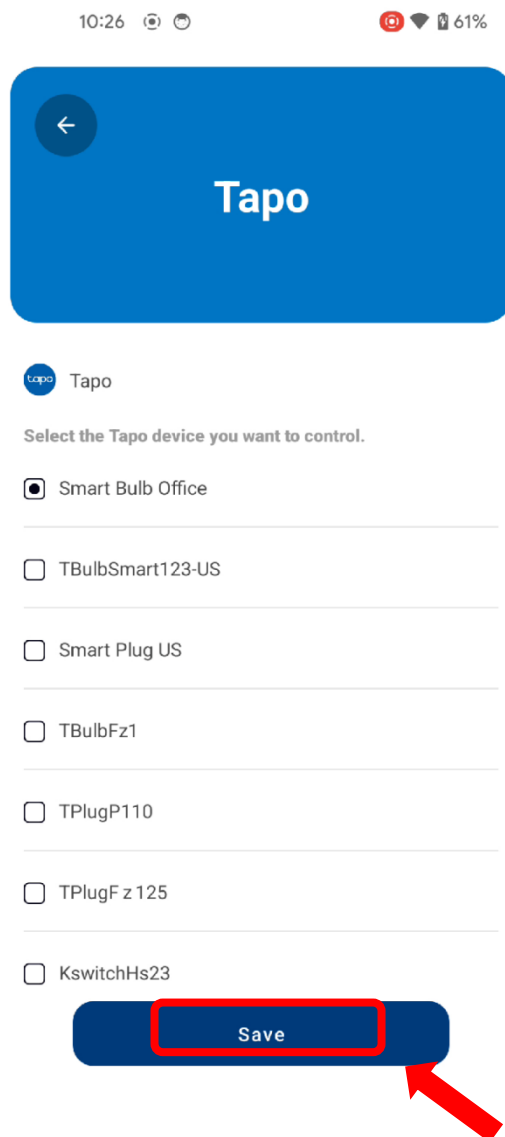

2. How to use Linxura to control the Tapo device.

Step 1:

Click the '+' icon to add a Click Action.

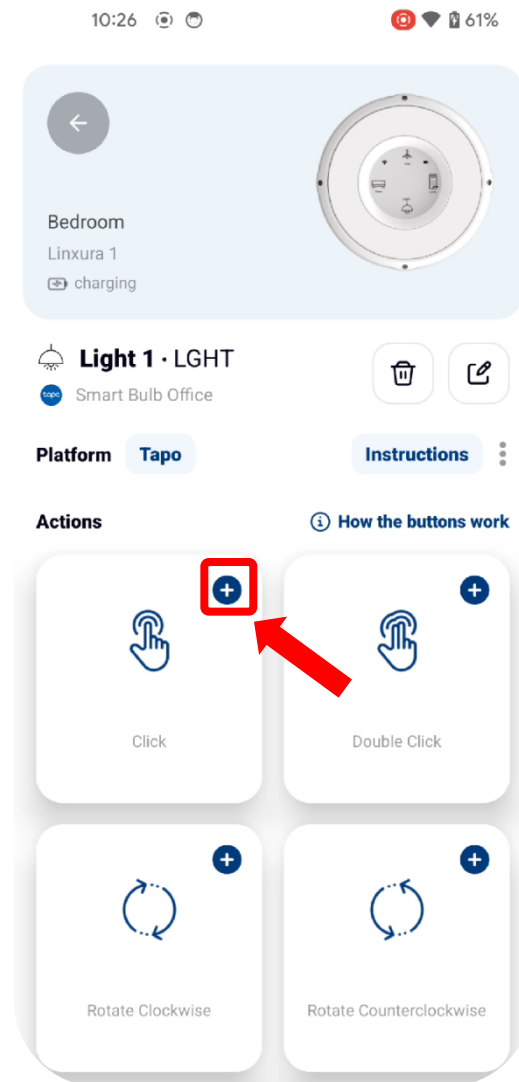

Step 2:
Click 'Mode' and select one of the options.

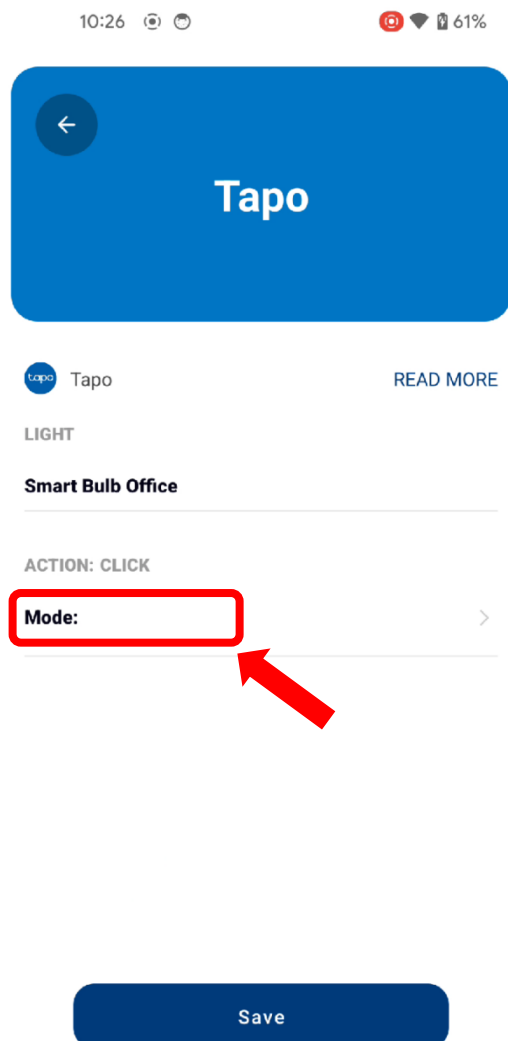

Step 3:
Select one of the 'Mode' options.

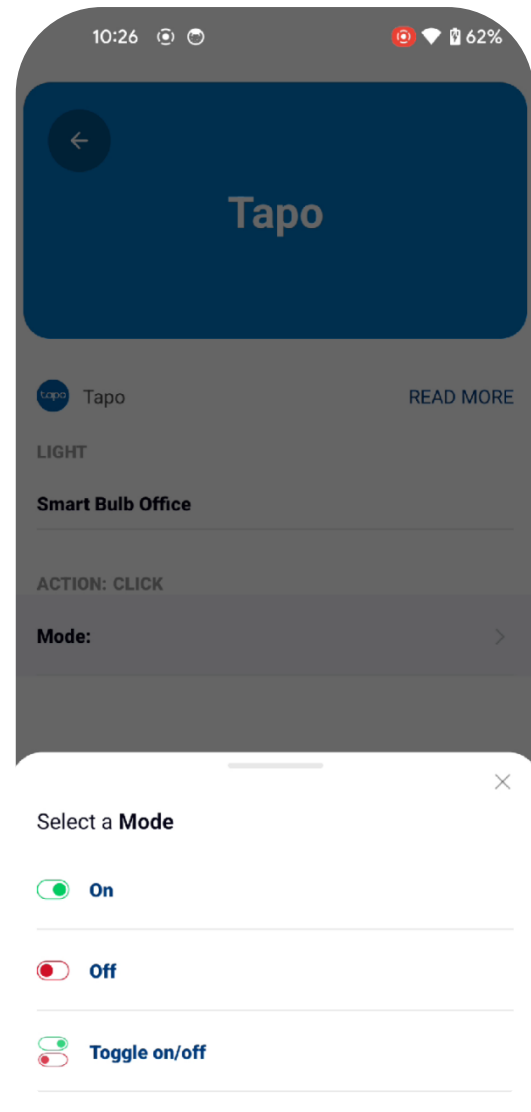

Step 4:

Configure the brightness, color, or color temperature as needed (optional). **Note that you can only configure either color or color temperature at a time.**

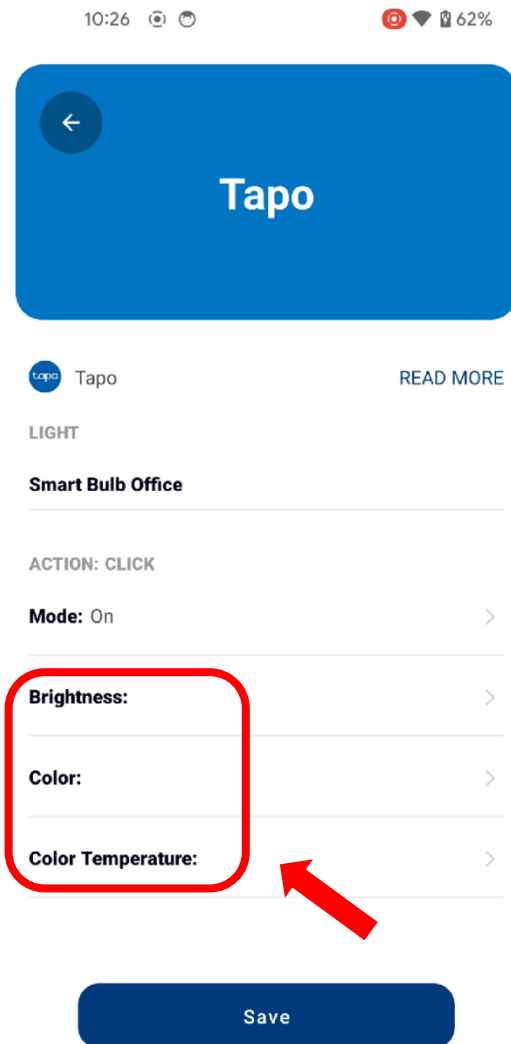

Step 5:

Click 'Save' to save the Click Action settings.

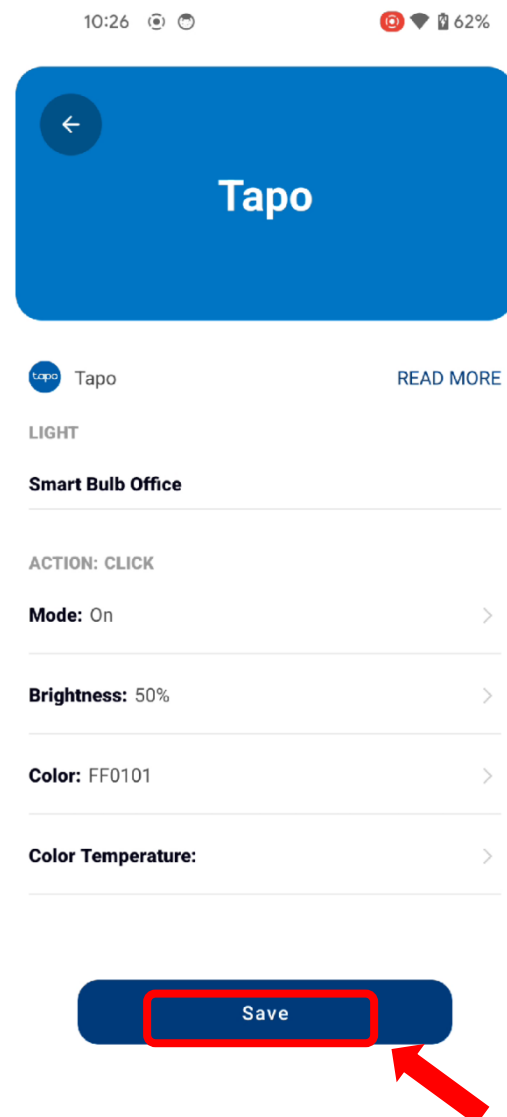

Step 6:

You can follow the same steps to configure Double Click, Rotate Clockwise, and Rotate Counterclockwise.

You can now use Linxura to control your Tapo device!

